

Instructions for combining
AC•THOR / AC•THOR 9s / AC ELWA 2
with
GoodWe Hybrid inverters



1 Basic settings on the my-PV device

Before commissioning, please ensure you read the installation instructions supplied with the device, as well as the operating instructions available online.

You can find the AC•THOR operating manual [here](#).

The AC ELWA 2 operating manual can be found [here](#).

2 Communication with the GoodWe inverter

The AC•THOR or AC ELWA 2 are connected to the GoodWe inverter via a router within the network. Within this network, the device receives information on the amount of surplus photovoltaic power available from the so-called "Wi-Fi + LAN module" on the GoodWe inverter.

The latest firmware must be active on the module and the inverter!

Note!

- Do not connect the my-PV device directly to the inverter or the battery system!
- When communicating with the device via the network, it is important that the IP address of the signal source does not change during operation (e.g. due to a DHCP router). Otherwise, the AC•THOR or AC ELWA 2 will lose the control signal.
- When controlling via an inverter query, a feed-in meter is required in the system. Otherwise, the inverter query will not provide any data!

3 Settings on the GoodWe inverter

Note!

The following information has been provided to my-PV by GoodWe. my-PV cannot guarantee the accuracy or currency of the information.

GoodWe note regarding ET:

- ET PLUS+ and ET PLUS+ (16A) with firmware version ARM 25 and higher (manufactured from April 2023 onwards) feature Modbus TCP, and the configuration methods for this are provided.
- The new Wi-Fi/LAN Kit 2.0 is compatible with the ET Plus from firmware version ARM 30 or higher.
- To avoid compatibility issues, we recommend updating the inverters via the supplied Bluetooth module before installing the Wi-Fi/LAN module.

service.de@goodwe.com

+49 32 221 092 721

Some older devices may require a DSP update in addition to the ARM update.

With these updates and 'LAN' selected as the Internet Access Point via the SolarGo or SEMS app, the required Modbus TCP is activated (**Modbus TCP is not available with a Wi-Fi connection**)

Activating the Modbus TCP interface

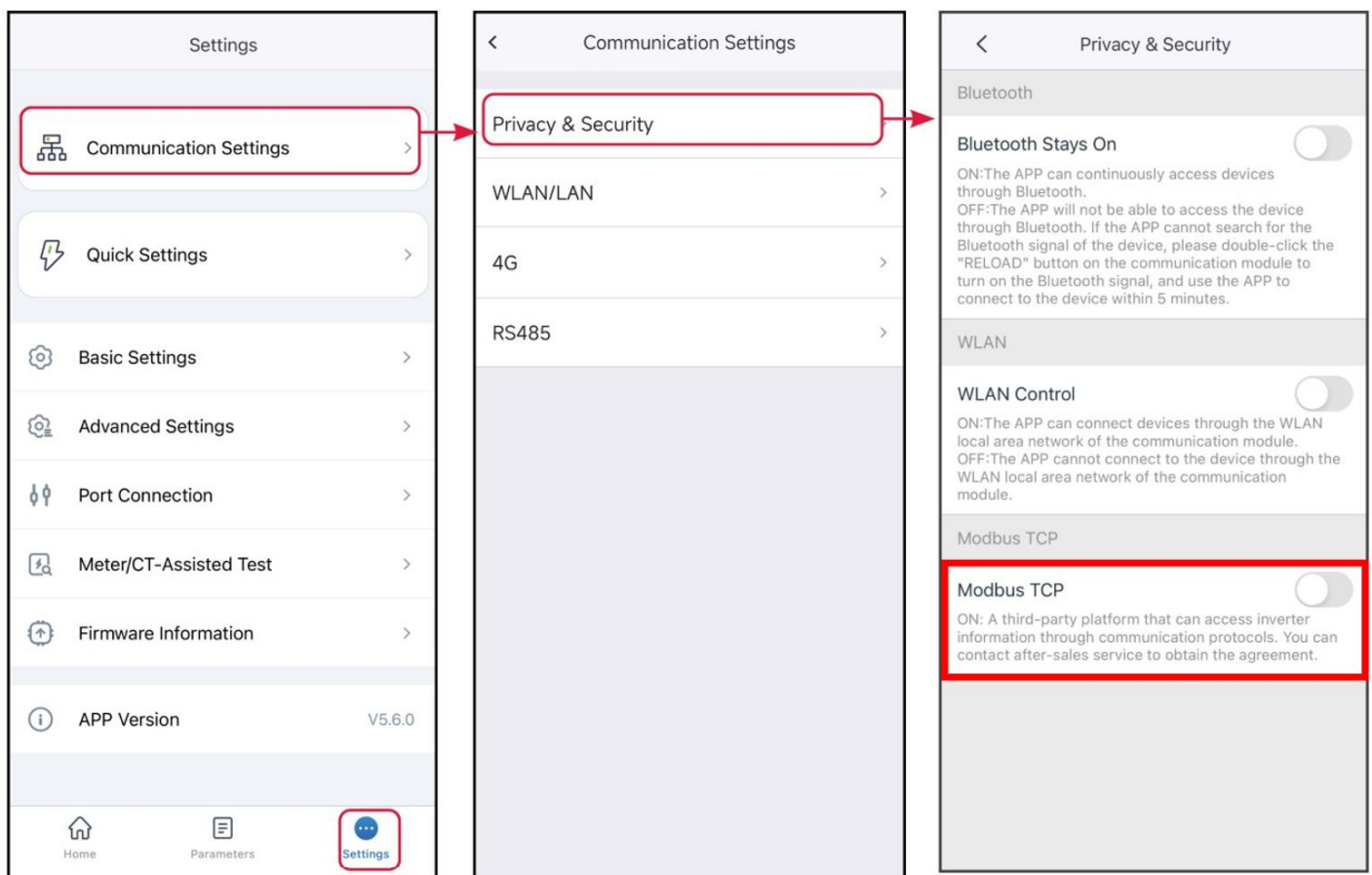

4 Settings on the my-PV device

For GoodWe, the communication parameters are preset from AC•THOR firmware version a0020512 onwards; for the AC ELWA 2, from firmware version e0000301 onwards.

On the display **or** in the web interface, select "**GoodWe manual**" under Control for the control type. On the display, then enter the IP address of the GoodWe inverter under "Ctrl IP".

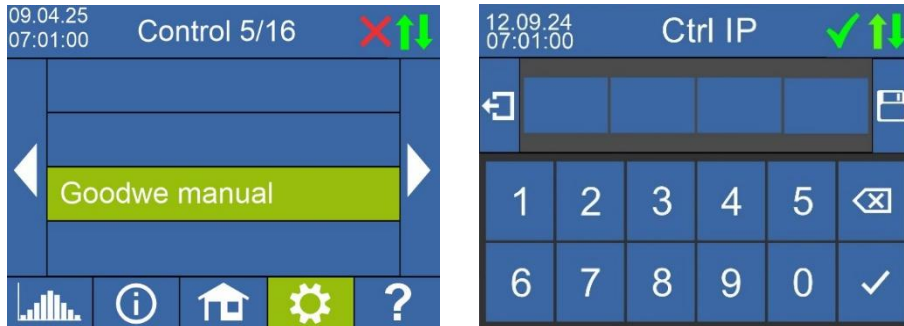

Alternatively, these settings can also be configured via the web interface.

In the web setup, the "Device ID" and "Device Port" parameters for the GoodWe inverter can also be adjusted if they differ from the default settings.

For the "GoodWe manual" control type, my-PV presets Device ID to 247 and Device Port to 502.

Control type	GoodWe Manual
Control source IP address	<input type="text"/>
Device ID	1
Device port	502
Control state	No Control
Power timeout	10 s
Control target	-50 W

The timing of the control should not be changed.

If a battery storage unit is present in the system and you wish to prioritise charging the battery storage unit, the "Control target value" should be left at -290 W. Otherwise, we recommend setting it to -50 W.

Subject to changes and printing errors.



my-PV GmbH
Betriebsstraße 12
4523 Neuzeug
www.my-pv.com